

MAIN FLOOR PLAN
SCALE: 1/4" = 1'-0"

SQUARE FOOTAGE	
FIRST FLOOR	1879
SECOND FLOOR	959
TOTAL	2832
CRAWL SPACE	1879
DECK/PORCH AREA	1404

- NOTE:
- 1) CONTRACTOR TO VERIFY ALL DIMENSIONS BEFORE BEGINNING CONSTRUCTION.
 - 2) ALL INTERIOR SLIP WALLS ARE NON-LOAD BEARING.
 - 3) ALL DOOR AND WINDOW ROUGH OPENINGS TO BE VERIFIED AS LOGS ARE BEING STACKED. OPENINGS MAY NEED TO BE ADJUSTED BY ADDING OR DELETING DOOR AND WINDOW PLUCKS OR BY CUTTING LOGS.
 - 4) EXTREME CARE IN PRE-CUTTING LOG OPENINGS HAS BEEN TAKEN. THE OWNER/CONTRACTOR IS RESPONSIBLE FOR CHECKING AND ADJUSTING OPENINGS WHEN STACKING LOGS.

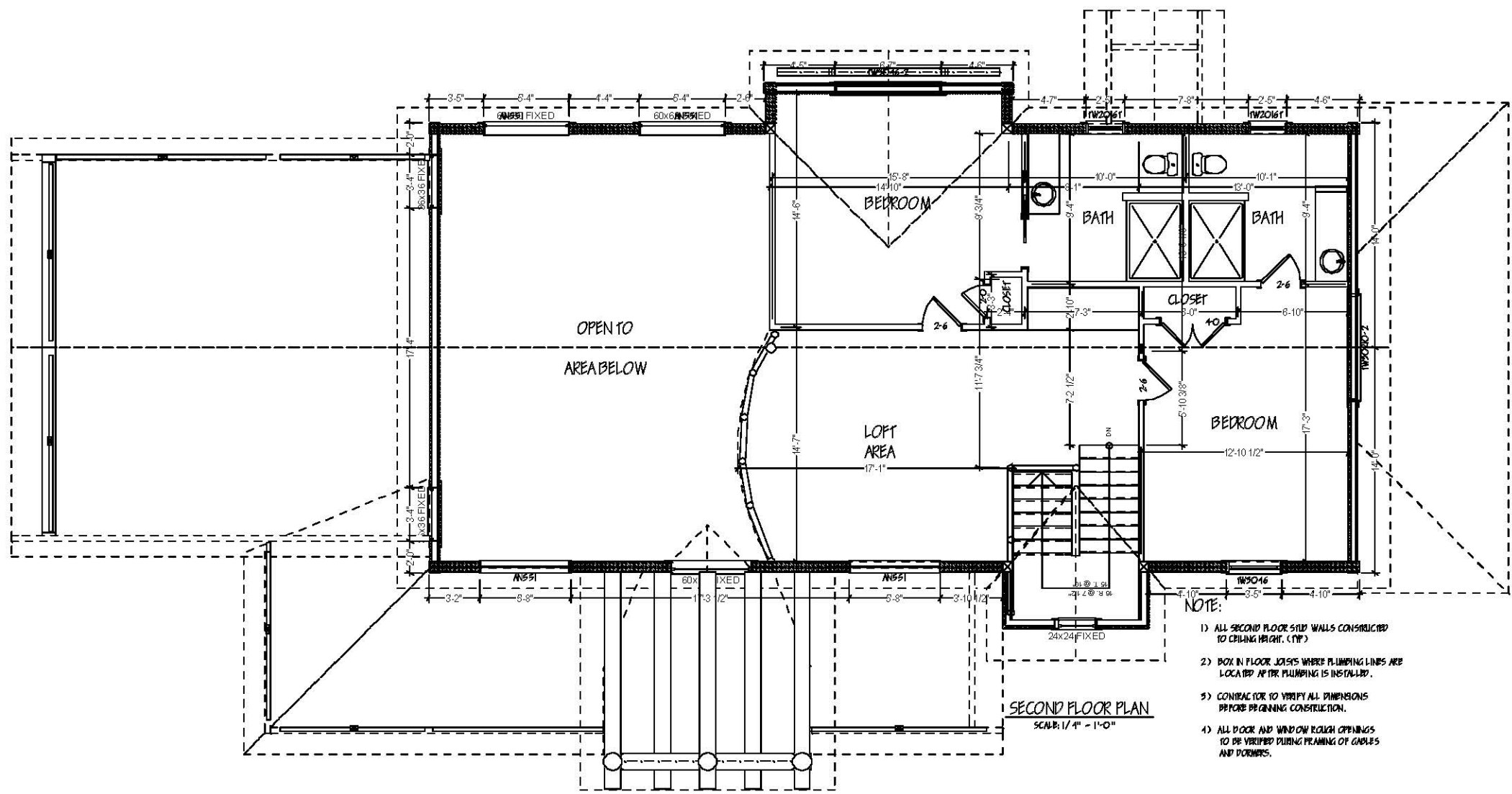

SECOND FLOOR PLAN
SCALE: 1/4" = 1'-0"

- NOTE:**
- 1) ALL SECOND FLOOR STUD WALLS CONSIDERED TO CEILING HEIGHT. (TYP)
 - 2) BOX IN FLOOR JOISTS WHERE PLUMBING LINES ARE LOCATED AFTER PLUMBING IS INSTALLED.
 - 3) CONTRACTOR TO VERIFY ALL DIMENSIONS BEFORE BEGINNING CONSTRUCTION.
 - 4) ALL DOOR AND WINDOW ROUGH OPENINGS TO BE VERIFIED DURING FRAMING OF GABLES AND DORMERS.